

3,339 sq. ft. | 4-6 Bedrooms | 2.5 Baths

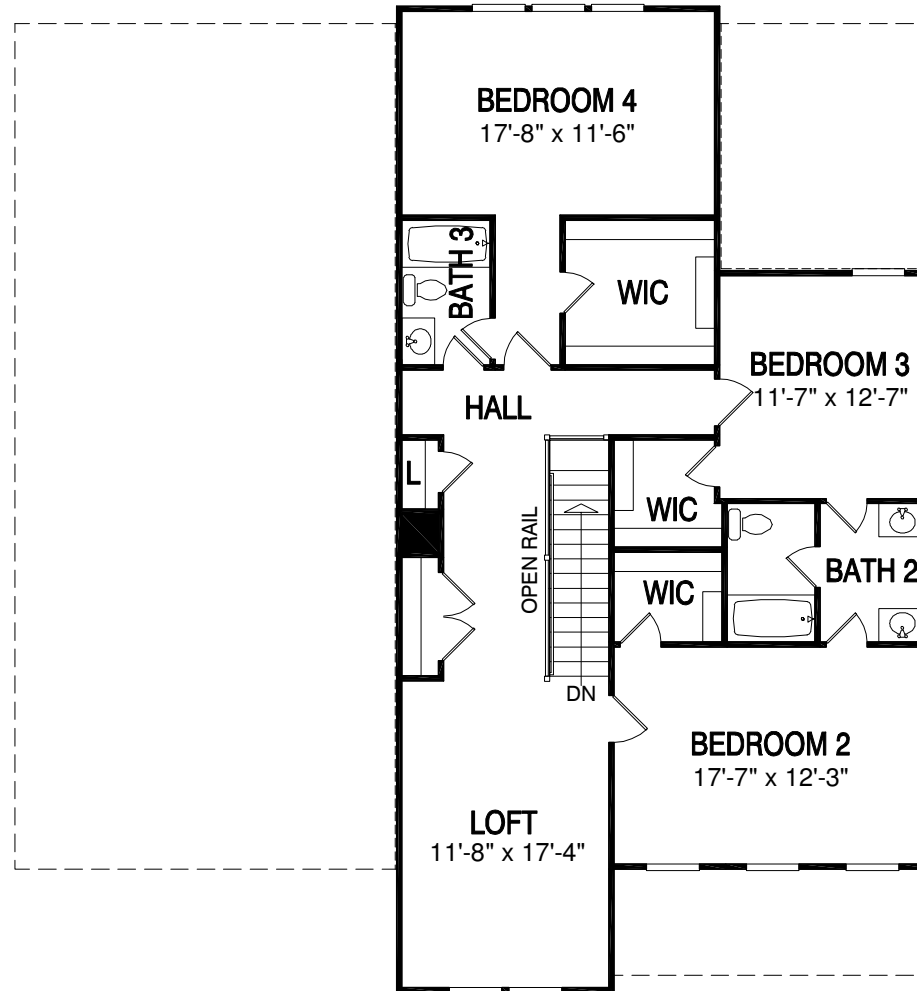

The renderings and site map depicted in this brochure represent artist concepts and are for illustrative purposes only. Please see your sales representative for specific details regarding the elevations, plans, pricing, dimensions, specifications, or products offered in the community. We reserve the right to make modifications or changes without notice or obligation. Photographs are for illustrative purposes only and are not intended to be an actual representation of a specific home being offered. This material shall not constitute a valid offer in any state where prior registration is required or if void by law. Please see a sales consultant for details. MHBR #516. ©2016 Pulte Home Corporation. All rights reserved.